



## **BELSIZE ROAD, SOUTH HAMPSTEAD £462pw / £2,000pm FURNISHED**

Beautifully refurbished one bedroom apartment set on the raised ground floor in a period house. The property offers a large open plan kitchen living room with floor to ceiling windows providing an abundance of natural light and a large bedroom with feature fireplace, high ceilings and plantation style shutters. Furthermore, the property has beautifully designed shower room. The property is offered furnished and is available now.

Newly Refurbished | One Bedroom | Open Plan | High Ceilings | Private Entrance |  
Furnished | Available Now

[winkworth.co.uk/st-johns-wood](https://www.winkworth.co.uk/st-johns-wood)

**Winkworth**

For every step...



# Belsize Road, London NW6

Raised Ground Floor  
GROSS INTERNAL FLOOR AREA  
APPROX. 51.13 SQ M / 550 SQ FT

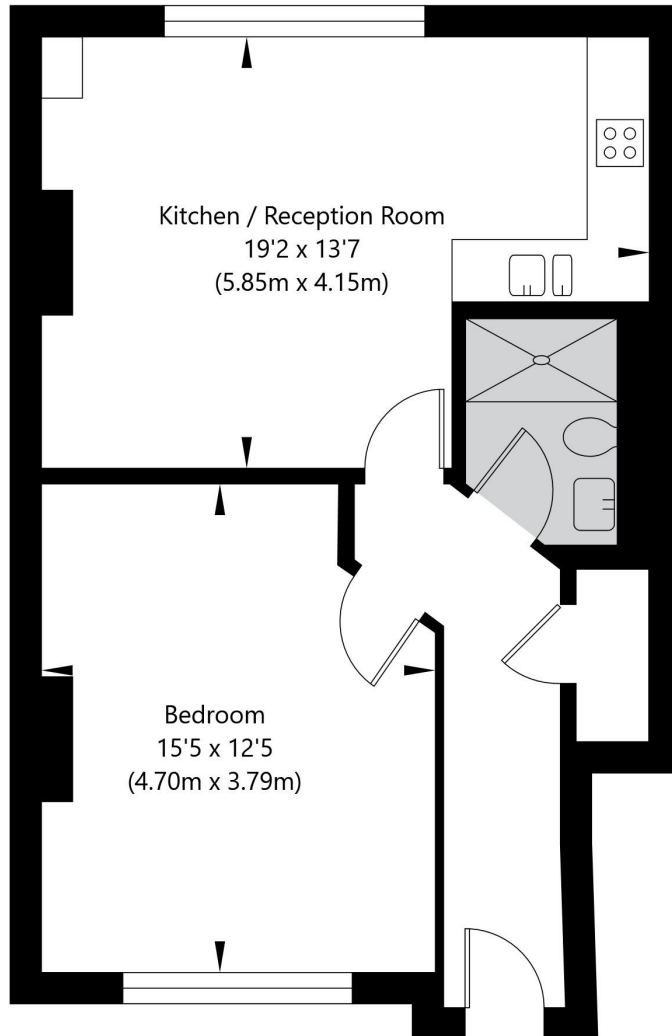

APPROXIMATE GROSS INTERNAL FLOOR AREA 51.13 SQ M / 550 SQ FT  
THIS FLOOR PLAN IS FOR ILLUSTRATIVE PURPOSES ONLY AND  
SHOULD BE USED FOR THIS PURPOSE BY PROSPECTIVE APPLICANTS AS ITS NOT TO SCALE.

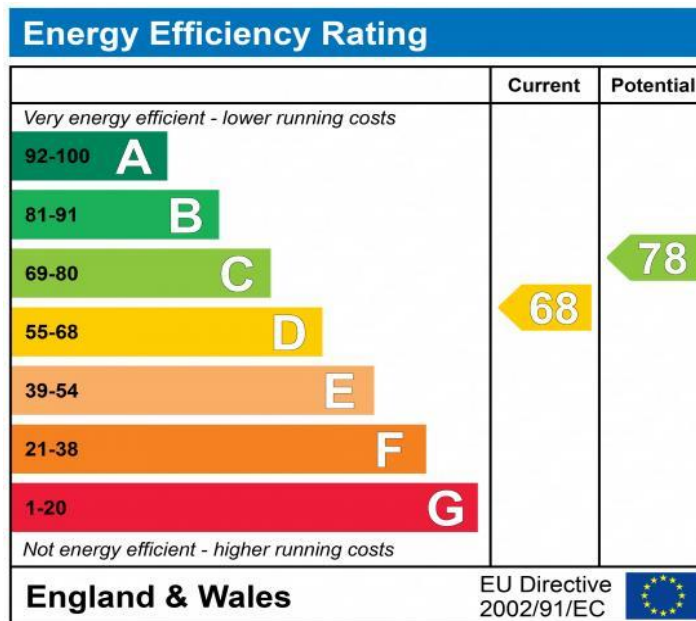

NB: These particulars are not an offer or contract, nor part of one. You should not rely on statements by Winkworth in the particulars or by word of mouth or in writing "information" as being factually accurate about the property, its condition or its value. Neither Winkworth nor any joint agent has any authority to make any representations about the property, and accordingly any information given is entirely without responsibility on the part of the agents, seller(s) or lessor(s). These particulars are prepared on the basis of the information supplied by our client and are a rough guide for information only. The photographs show only certain parts of the property. We are not able to check all of the information and therefore are unable to guarantee accuracy. All interested parties are therefore advised to undertake all necessary inspections and checks that they deem appropriate. Where displayed, the square footage is taken from the floor plans, which are created by an independent supplier. These measurements are approximate and included for illustrative purposes only. The measurements may vary. Winkworth does not make any representation as to the accuracy of these measurements and you should seek to verify them for yourself. Winkworth accept no liability for any loss you may suffer if you rely on these measurements. All fixtures and fittings, whether fitted or not are deemed removable by the vendor unless stated. Any reference to alterations to, or use of, any part of the property does not mean that any necessary planning, building regulations or other consent has been obtained. Amenities and appliances have not been tested.

St John's Wood | 103-104 St John's Wood Terrace, London NW8 6PL  
020 7586 7001 | [stjohnswood@winkworth.co.uk](mailto:stjohnswood@winkworth.co.uk)

