



Upper Addison Gardens

Kensington, W14



Upper Addison Gardens

Kensington, W14

An immaculate apartment located in this tree lined street in Holland Park. The apartment boasts hard wooden floors to beautiful reception, separate kitchen with breakfast bar, high ceilings and modern bathrooms.

Centrally located within walking distance to the shops and restaurants of Holland Park Avenue as well as Westfield Shopping Centre.

2 bedrooms, 2 bathrooms (one en suite), reception room, kitchen. EPC Rating C.

LONG LET: £525 PER WEEK (FEES APPLY)

LOCAL AUTHORITY: RBKC

ENERGY RATING: C

CONSUMER PROTECTION FROM UNFAIR TRADING REGULATIONS 2008. THIS BROCHURE AND THE DESCRIPTIONS AND MEASUREMENTS HEREIN DO NOT CONSTITUTE REPRESENTATION AND WHILST EVERY EFFORT HAS BEEN MADE TO ENSURE ACCURACY, THIS CANNOT BE GUARANTEED.

KENSINGTON OFFICE

T 020 7795 4288

10 HORNTON STREET, KENSINGTON, LONDON, W8 4NW

E KENSINGTON@BECTIVE.CO.UK

WWW.BECTIVE.CO.UK

Upper Addison Gardens, W14

Approximate Gross Internal Area = 69 sq m / 743 sq ft

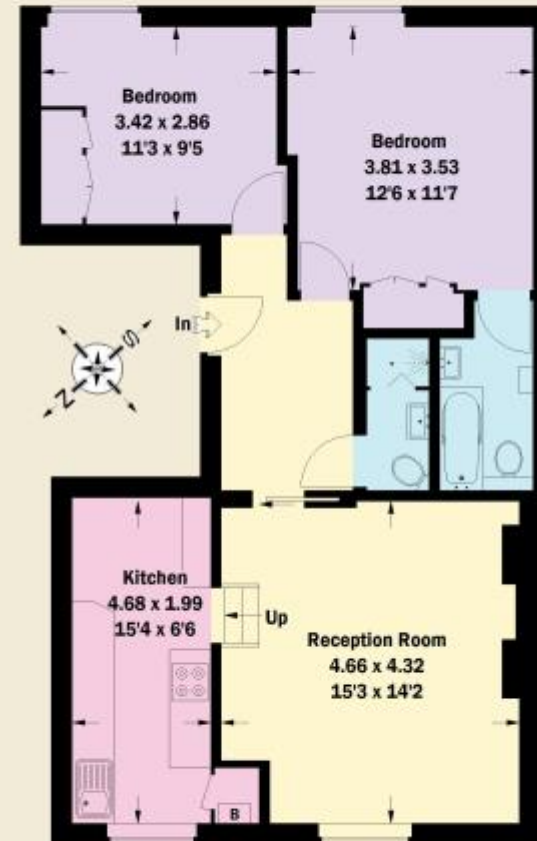

Second Floor

Whilst every attempt has been made to ensure the accuracy of this floor plan, measurements are approximate and not to scale. The guarantee is given in the full square footage of the property quoted on the plan. Figures given are for guidance. Plan is for illustration purposes only, not to be used for valuations.

BECTIVE
- LESLIE MARSH -